

**we-ef**

**WE-EF LIGHTING USA LLC**

410-D Keystone Drive  
Warrendale, PA 15086  
USA  
Tel +1 724 742 0030  
Fax +1 724 742 0035  
info.usa@we-ef.com  
www.we-ef.com

**we-ef**

**WE-EF LIGHTING USA LLC**

Installation and Maintenance  
Instructions for Surface Mounted Projectors  
**FLC121 LED Ceon Arm**  
**FLC131 LED Ceon Arm**  
**FLC141 LED Ceon Arm**

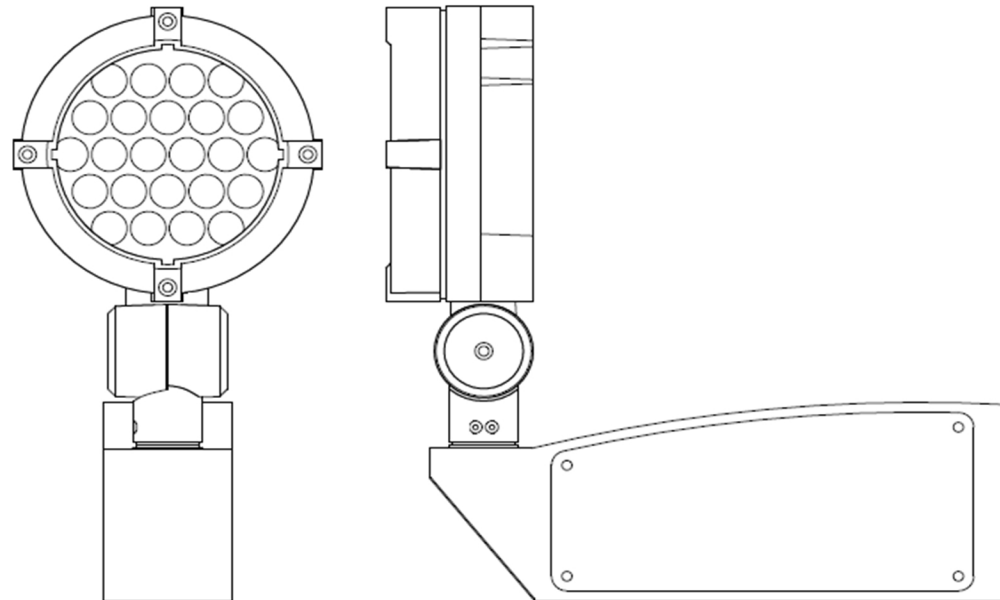

Technical specifications are subject to change  
© WE-EF 2013

## Installation and Maintenance Instructions for Surface Mounted Projectors:

### FLC121 LED Ceon Arm

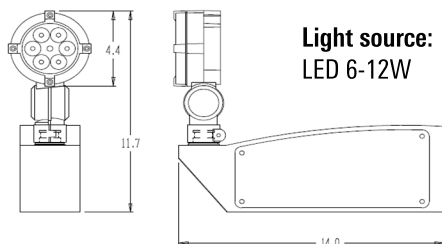

### FLC131 LED Ceon Arm

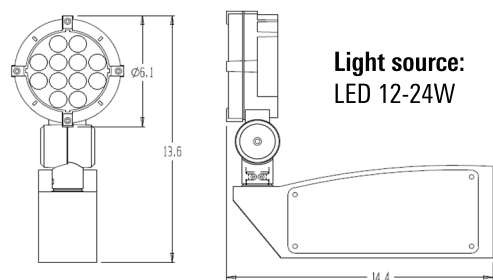

### FLC141 LED Ceon Arm

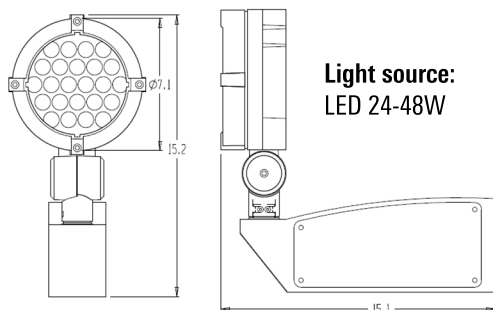

### FLC100 LED Ceon Arm Mounting

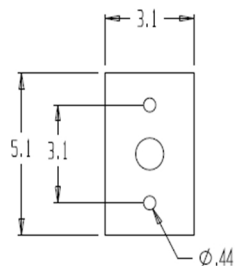

This product should be installed in accordance with the applicable installation code by a person familiar with the construction and operation of the product and the hazards involved. Be sure the electrical supply is off prior to installation.

These fixtures are intended to be mounted over and attached to a recessed 4" octagon box.

- 1) Remove gear box cover A by loosening the socket head screws B.
- 2) Check that the electrical supply conforms to the ratings shown on the fixture labels.
- 3) Feed the electrical supply wire through the cord grip C, while attaching the luminaire to the mounting surface.
- 4) Secure the luminaire with fasteners that are appropriate for the mounting surface E (by others).
- 5) Make the electrical connection.
- 6) Reposition cover A and tighten screws B evenly.
- 7) Aim the luminaire by slightly loosening screws K, aim in the desired direction and retighten screws K firmly.

### Lamp Replacement and Maintenance:

Do not open luminaire while in operation or while mains supply is switched on!

Apart from cleaning the product's exterior surfaces, no special maintenance work is required. Do not use high-pressure washers.

Protect our environment: Discard used lamps in compliance with the most recent environmental legislation.

